

Modal/ODS Triaxial Accelerometer, 100 mV/g, ± 5%

Actual Product Size Shown



Must Use J4A, J4C or J4N Connectors
Must Use CB105, CB117, CB119 or CB218 Cables

Product Features

Modal/ODS Triaxial Sensor

Collect 3 Axes of Data for Modal Analysis and ODS (Operating Deflection Shape)

- Premium 100 mV/g, ±5% Sensitivity
- Phase conforms to Cartesian Coordinate System (Right Hand Rule)

AC360-1D

4 Pin Connector

Asima DDU Compatible		Asima DDU Compatible	
Connector Pin	Polarity	Connector Pin	Polarity
A	Axis Y (+) Signal/Power	A	Axis 3 (+) Signal/Power
B	Axis X (+) Signal/Power	B	Axis 2 (+) Signal/Power
C	Axis Z (+) Signal/Power	C	Axis 1 (+) Signal/Power
D	(+) Common/Grid	D	(+) Common/Grid

AC360-2D

Integral Cable

Asima DDU Compatible		Asima DDU Compatible	
Conductor	Polarity	Conductor	Polarity
Red	Axis Y (+) Signal/Power	Red	Axis 3 (+) Signal/Power
Green	Axis X (+) Signal/Power	Green	Axis 2 (+) Signal/Power
White	Axis Z (+) Signal/Power	White	Axis 1 (+) Signal/Power
Black	(+) Common/Grid	Black	(+) Common/Grid

AC360-3D

Armored Integral Cable

Asima DDU Compatible		Asima DDU Compatible	
Conductor	Polarity	Conductor	Polarity
Red	Axis Y (+) Signal/Power	Red	Axis 3 (+) Signal/Power
Green	Axis X (+) Signal/Power	Green	Axis 2 (+) Signal/Power
White	Axis Z (+) Signal/Power	White	Axis 1 (+) Signal/Power
Black	(+) Common/Grid	Black	(+) Common/Grid

Operating Deflection Shape created from vibration and phase measurements.

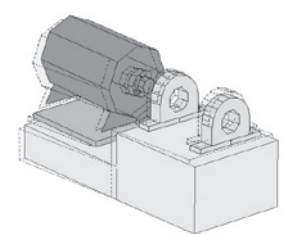

Specifications	Standard	Metric
Part Number	AC360	M/AC360
Sensitivity (±5%)	100 mV/g	
Frequency Response (±3dB)	36-600,000 CPM	0,6-10000 Hz
Frequency Response (±10%)	60-390,000 CPM	1,0-6500 Hz
Frequency Response (±5%)	480-330,000 CPM	8,0-5500 Hz
Dynamic Range	± 50 g, peak	
Electrical		
Settling Time	<2.5 seconds	
Voltage Source (IEPE)	18-30 VDC	
Constant Current Excitation	2-10 mA	
Spectral Noise @ 10 Hz	27 µg/√Hz	
Spectral Noise @ 100 Hz	6.5 µg/√Hz	
Spectral Noise @ 1000 Hz	2.5 µg/√Hz	
Output Impedance	<100 ohm	
Bias Output Voltage	10-14 VDC	
Case Isolation	>10 ⁸ ohm	

Specifications	Standard	Metric
Environmental		
Temperature Range	-65 to 250°F	-54 to 121°C
Electromagnetic Sensitivity	CE	
Sealing	IP68	
Submersible Depth (AC360-2D/3D)	200 ft.	60 m
Physical		
Sensing Element	PZT Ceramic	
Sensing Structure	Shear Mode	
Weight	7.1 oz	200 grams
Case Material	316L Stainless Steel	
Mounting	1/4-28	
Connector (non-integral)	4 Pin	
Mounting Torque	1 to 2 ft. lbs.	1,4 to 2,7 Nm
Mounting Hardware	1/4-28 Captive Bolt	M6x1 Captive Bolt
Calibration Certificate	CA10	

Ordering Information

Standard	AC360-1D (1/4-28 Captive Bolt)	AC360-2D / (1/4-28 Captive Bolt)	AC360-3D / (1/4-28 Captive Bolt)
	(length in feet) (termination)	(length in feet) (termination)	(maximum armor length 100 ft.) (cable length in feet) (termination)
Metric	M/AC360-1D (M6x1 Captive Bolt)	M/AC360-2D / (M6x1 Captive Bolt)	M/AC360-3D / (M6x1 Captive Bolt)
	(length in meters) (termination)	(length in meters) (termination)	(maximum armor length 30 m) (cable length in meters) (termination)

CTC multi-conductor cable

Red = Y axis
 Green = X axis
 White = Z axis
 Black = Common

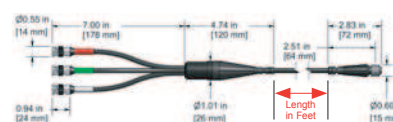

Backed by our Unconditional Lifetime Warranty