

# AC155 Series

## Low Cost Modal/ODS Triaxial Accelerometer, Top Exit Connector, 100 mV/g

SECTION 1 - VIBRATION SENSORS  
Accelerometers



Actual Product Size Shown



**Must Use J4A, J4C or J4N Connectors**  
**Must Use CB105, CB117, CB119 or CB218 Cables**

### Product Features

#### Modal/ODS Triaxial Sensor

Collect 3 Axes of Data for Modal Analysis and ODS (Operating Deflection Shape)

- 100 mV/g,  $\pm 15\%$  Sensitivity
- Phase conforms to Cartesian Coordinate System (Right Hand Rule)

### AC155-1D

4 Pin Connector

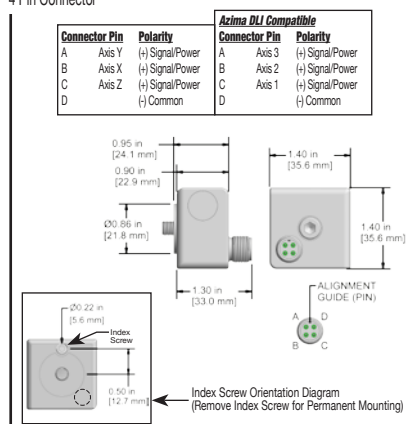

Operating Deflection Shape created from vibration and phase measurements.

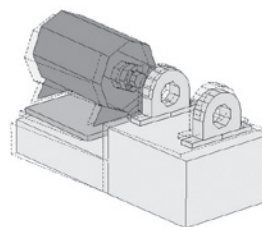

Specifications	Standard	Metric
Part Number	AC155	M/AC155
Sensitivity ( $\pm 15\%$ )		100 mV/g
Frequency Response ( $\pm 3\text{dB}$ )	36-390,000 CPM	0,6-6500 Hz
Dynamic Range		$\pm 50$ g, peak
<b>Electrical</b>		
Settling Time		<2.5 seconds
Voltage Source (IEPE)		18-30 VDC
Constant Current Excitation		2-10 mA
Spectral Noise @ 10 Hz		27 $\mu\text{g}/\sqrt{\text{Hz}}$
Spectral Noise @ 100 Hz		6.5 $\mu\text{g}/\sqrt{\text{Hz}}$
Spectral Noise @ 1000 Hz		2.5 $\mu\text{g}/\sqrt{\text{Hz}}$
Output Impedance		<100 ohm
Bias Output Voltage		10-14 VDC
Case Isolation		>10 <sup>8</sup> ohm

Specifications	Standard	Metric
<b>Environmental</b>		
Temperature Range	-65 to 250°F	-54 to 121°C
Electromagnetic Sensitivity		CE
Sealing		Welded, Hermetic
<b>Physical</b>		
Sensing Element		PZT Ceramic
Sensing Structure		Shear Mode
Weight	7.1 oz	200 grams
Case Material		316L Stainless Steel
Mounting		1/4-28
Connector (non-integral)		4 Pin, J Series Connector
Mounting Torque	1 to 2 ft. lbs.	1,4 to 2,7 Nm
Mounting Hardware*	1/4-28 Captive Bolt	M6x1 Captive Bolt
Indexing Screw	Provided for consistent axis orientation, may be removed in permanent installations	
Calibration Certificate		CA10

\*MH108-11B Adapter Screw 10-32 is Optional

### Ordering Information

Standard	AC155-1D (1/4-28 Captive Bolt)	
Metric	M/AC155-1D (M6x1 Captive Bolt)	

Backed by our Unconditional Lifetime Warranty

[www.ctconline.com](http://www.ctconline.com)

